

**Jai Mata Di**

**Shivam Singh**

(Director)

**9582006738**

**9911006738**

# **Sangam Associates**

REAL ESTATE AGENTS & FINANCE ADVISOR

**SALE ★ PURCHASE ★ RENTING**

**Deals in : Residential & Commercial all kinds of Properties**

Off.: Shop No.-06, GF Galaxy Shoppe, Gaur City-2, Sec.-16C, Gr. Noida (W)

H.Off.: 4/304, Opp. Metro Suites, Vaishali, Gzb.

E-mail : shivam.singhgzb@gmail.com



GALAXY  
**BLUE  
SAPPHIRE  
PLAZA**  
GREATER NOIDA WEST



Great Things Happen  
When Galaxy Gets Involved





## one of its kind across Delhi - NCR

### A Solitaire of Investment

Galaxy Blue Sapphire Plaza is a three side open plot, facing the 130 metre, 45 metre and 24 metre road respectively. It is surrounded by a residential society of up to 25,000 flats, all that are walking distance. Furthermore, to attract clientele of all ages, the Blue Sapphire Plaza offers a 12 screen multiplex, food court, doctor's chambers, high street retail shopping and large anchors on different floors. To top it all off, it is one of the largest commercial projects within the commercial belt of Noida Extension, encompassing an area off almost 25,661 square meters.

### Near to Upcoming Metro Station

The Metro is not just changing the way people commute in NCR; it is also changing the way shop, work and celebrate. The upcoming metro close to **"Galaxy Blue Sapphire Plaza"** will change the dynamics of shopping by providing shoppers and fun seekers the much-needed freedom, mobility and peace of mind. the world of extraordinary surprises comes closer and closer to you.





GALAXY  
**BLUE  
SAPPHIRE  
PLAZA**  
GREATER NOIDA WEST



The Greater Noida (West) is making headlines for its incredible infrastructure development, property investment and fast evolving urban lifestyle. The future of the area is bright in terms of price appreciation and connectivity. An investor's paradise, it's one of the most enviable destinations in NCR, Where everything is well planned with all basic amenities and world-class facilities.

- Ample Multi-Level/Basement Mechanical Car Parking Space
- Commercial Project on 130 Mtr. Wide road
- 3 Side Entry Plot
- Next to proposed Metro Station Kisan-Chowk, 1st Metro Station of Greater Noida (W)
- 12 Screen Multiplex with Exclusive Food Court
- 24x7 Hours Security with CCTV
- Studios Service Apartment
- 25,661 Sq. Mtrs. Plot Area
- Captive Clientele of 3-3.5 Lac Families
- One of the largest Entertainment Zone



# site plan

## FLOOR DETAILS

<b>Lower Ground Floor</b>	: Retail Shops, Hyper Market and Anchor Store
<b>Ground Floor</b>	: Showrooms, Anchor Store, Bank Space & Retail Shops.
<b>First Floor</b>	: Retail Shops, Showrooms and Anchor Store.
<b>Second Floor</b>	: Bangkok Bazaar, Retail Shops and Institutional area.
<b>Third Floor</b>	: Anchor Store, Retail Market and Medicentre (Doctor's OPD).
<b>Fourth Floor</b>	: 12 Screen Multiplex ,F & B Cafe, Restaurant and Food Court with Huge Sitting Area (Air Condition & Open Area).
<b>Fifth, Sixth &amp; Seventh Floor</b>	: Multiplex, Disco & Pub, Big Entertainment Zone and Double Height Banquet Hall, Multilevel Parking and open to Sky Terrace on various Floors.
<b>Eight Floor &amp; Above</b>	: Studios/Service Apartments & Office Spaces.



24 METER WIDE ROAD

ENTRY/EXIT

6 METER WIDE ROAD

6 METER WIDE ROAD

MULTIPLEX

TOWER B

6 METER WIDE ROAD

45 METER WIDE ROAD

TOWER A

6 METER WIDE ROAD

6 METER WIDE ROAD

130 METER WIDE ROAD

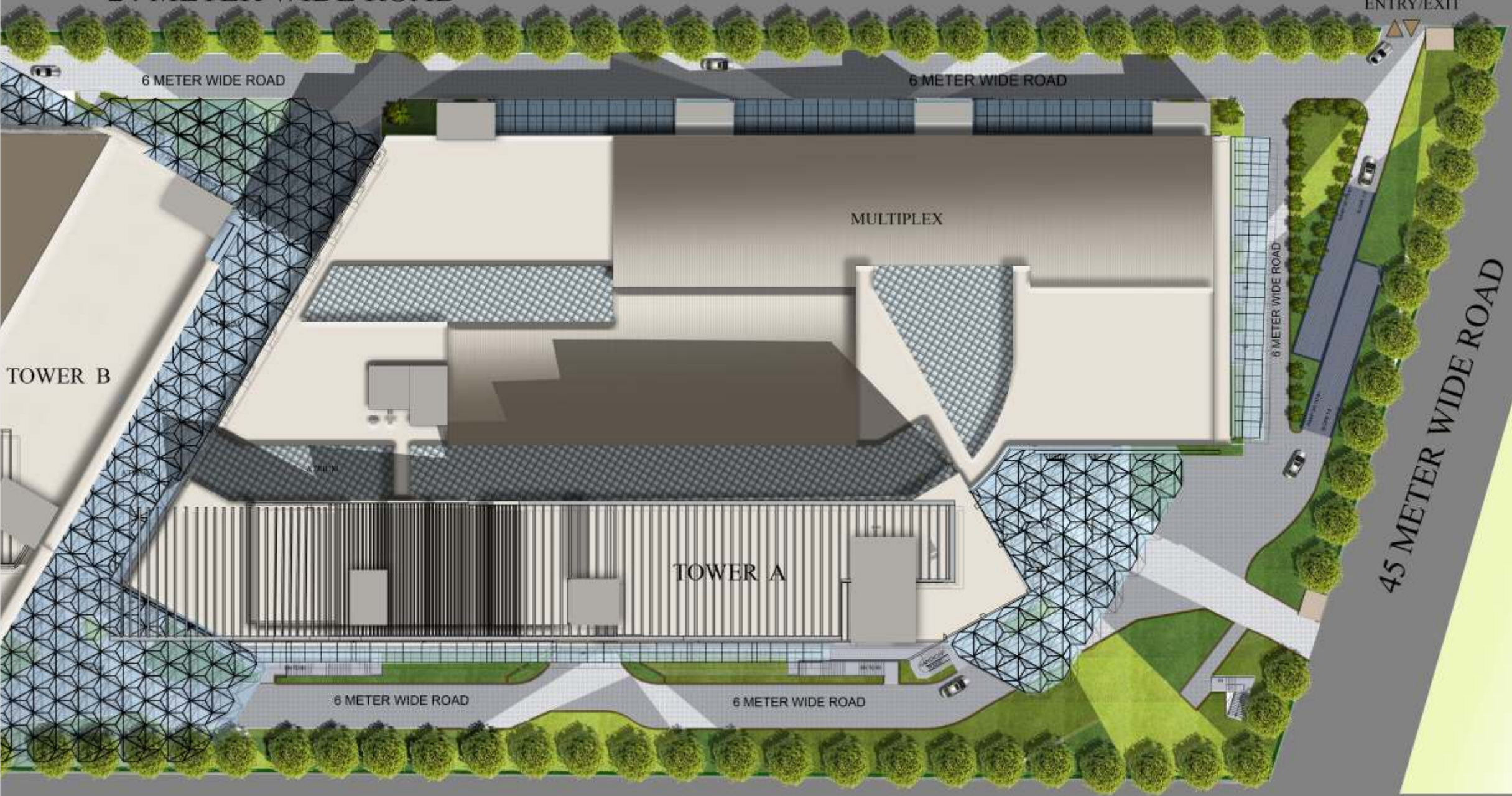













# retail & hyper market

**INTELLIGENTLY PLANNED STRUCTURE FOR OPTIMUM  
NATURAL AIR & LIGHT**

Galaxy Blue Sapphire Plaza Have International & National Brands In High Street Retail Shops & Mini Anchor Area spread across various floors

# lower ground floor plan



- |  |  |  |  |   |
|--|--|--|--|---|
|  POCKET-A |  POCKET-C |  POCKET-E |  ANCHOR |  KIOSK       |
|  POCKET-B |  POCKET-D |  POCKET-F |  HYPER  |  MINI ANCHOR |

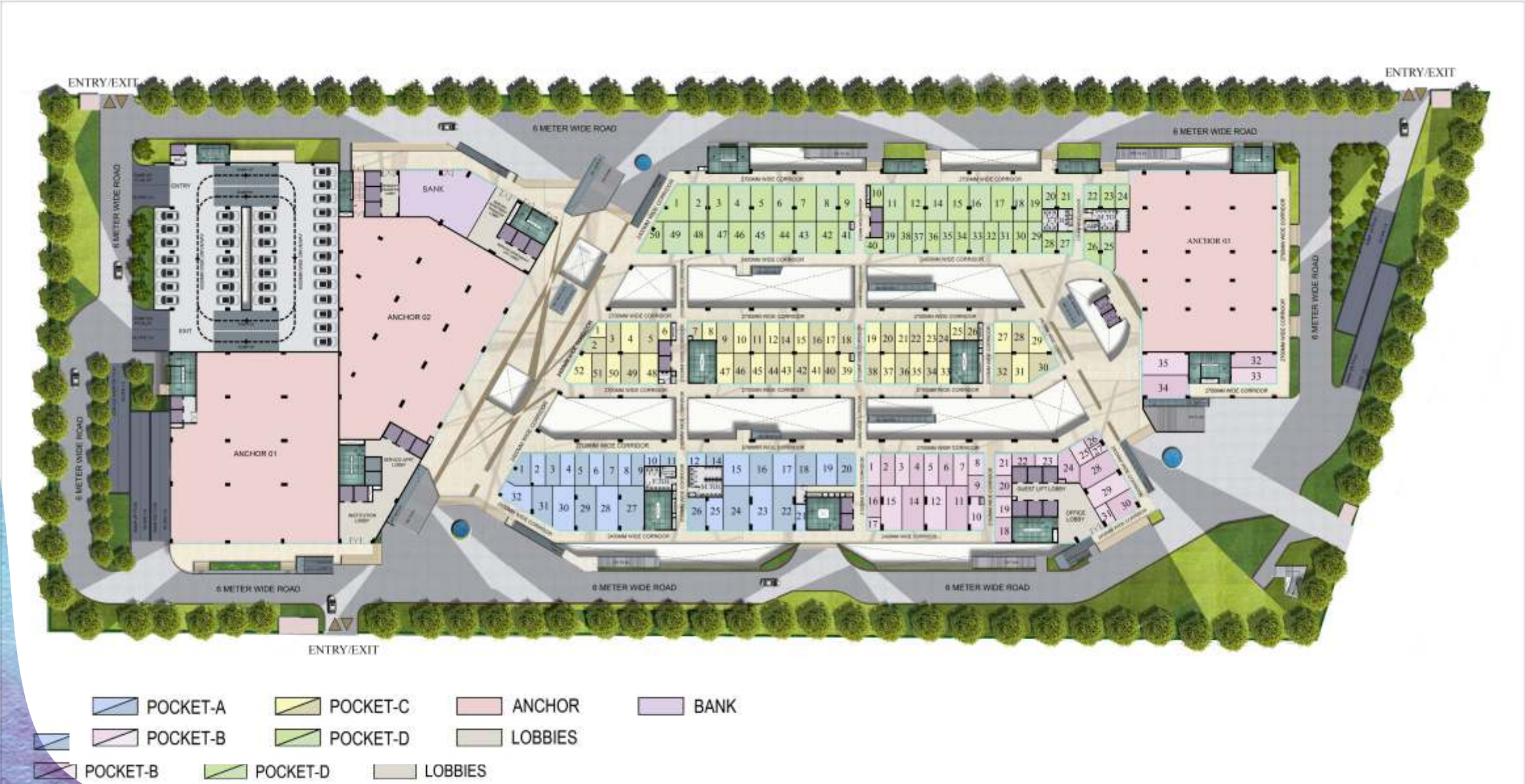

- |          |          |         |      |
|----------|----------|---------|------|
| POCKET-A | POCKET-C | ANCHOR  | BANK |
| POCKET-B | POCKET-D | LOBBIES |      |
| POCKET-B | POCKET-D | LOBBIES |      |

GALAXY BLUE SAPPHIRE PLAZA - GROUND FLOOR SALE PLAN

# first floor plan

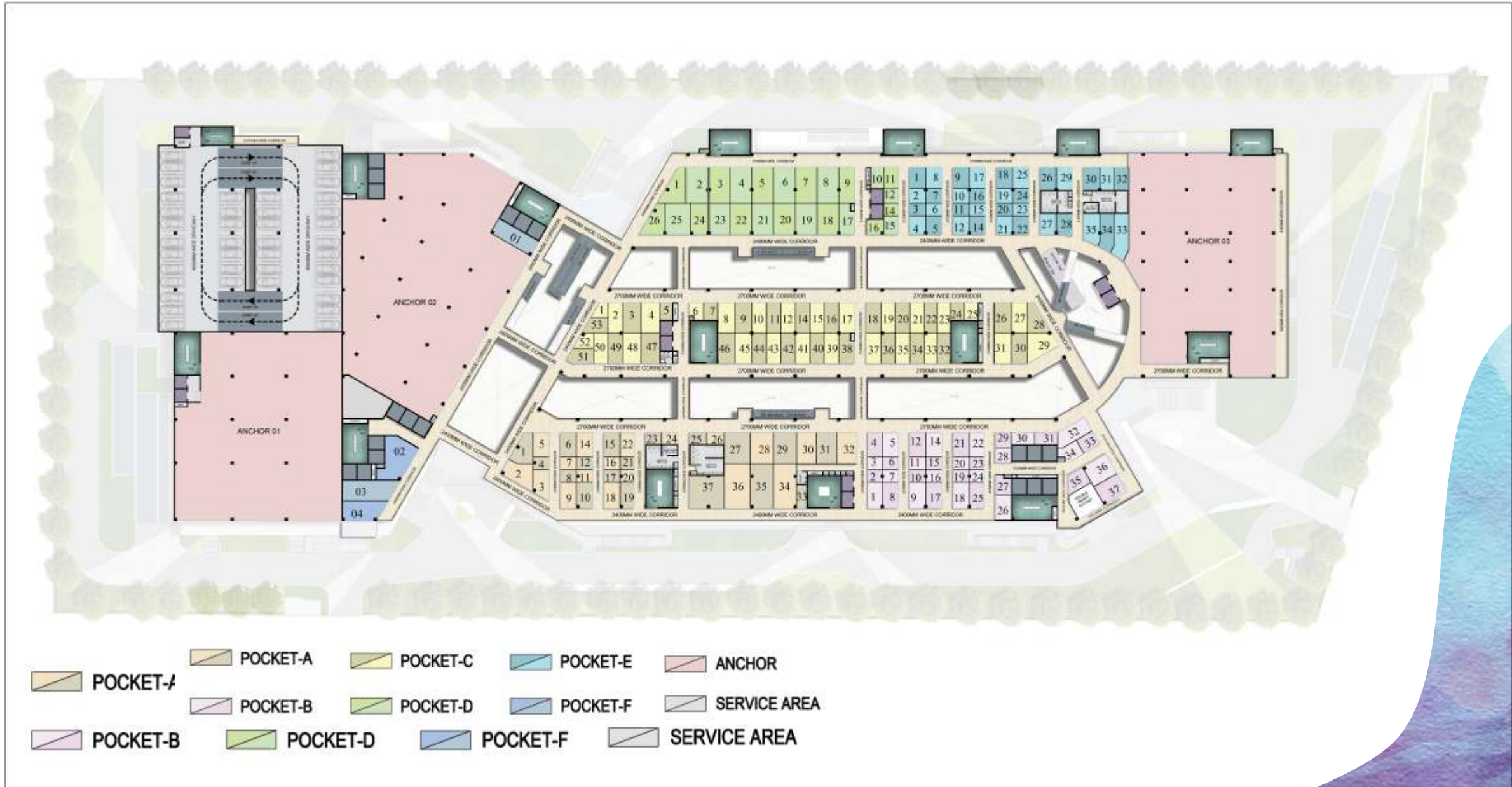

**GALAXY BLUE SAPPHIRE PLAZA - FIRST FLOOR SALE PLAN**





# bangkok bazaar

Markets around Bangkok offer fascinating shopping experiences. Shops selling everything from one-off Fashion Accessories, Fashion Wear, Shoes, Mobile Accessories etc. will be available in Bangkok Bazaar.

- Bangkok Bazaar 1st Time in Delhi NCR.
- Bangkok Bazaar spread over 70000 sq. ft. area on second floor.
- Dedicated shopping hub resembles to famous shopping destination in Bangkok.
- Available small size shops with low maintenance.
- Bangkok Bazaar pull big crowd like Palika Bazaar & Sarojini Nagar market in Delhi.

# second floor plan



- |  |  |   |   |   |
|--|--|---|---|---|
|  POCKET-A |  POCKET-C |  POCKET-E |  ANCHOR      |  SHOPS |
|  POCKET-B |  POCKET-D |  POCKET-F |  INSTITUTION |  KIOSK |



# medicentre floor

Medicentre floor offers a wide range of health services. Experience Doctor's with specialization in various stream of medicine will be available on common floor.

- Dedicated Floor for Doctor's OPD.
- Centrally Air Conditioned Environment for Doctors & Patients.
- Separate Lift with Wheel Chair Facility.
- Exclusive Reception & Waiting Lounge for Patients.
- Wet Point in each Doctor's Room.
- Ample Waiting Area for Patients outside Doctor's Room.
- Exclusive Entry for Doctor's from Multi-Level Parking.
- Pharmacy / Diagnostics Center within Complex.
- Excellent Location with three Side Major Roads.

# third floor plan



- POCKET-A**
- POCKET-C**
- POCKET-E**
- ANCHOR**
- SHOPS**
- POCKET-B**
- POCKET-D**
- POCKET-F**
- DOCTOR'S**
- KIOSK**

**GALAXY BLUE SAPPHIRE PLAZA - THIRD FLOOR SALE PLAN**

# food court

Food courts consist of a number of vendors at food stalls or service counters. Meals are ordered at one of the vendors and then carried to a common dining area. The food may also be ordered as takeout for consumption at another location, such as a home, or workplace. In this case, it may be packaged in form of food containers. Branded outlet & Regional Delicacies will be served across the counters.

- Food Court is Strategically placed on 4th Floor along with Mega Multiplex to attract large foot fall.
- Modernly designed large sitting & Dining area for approx 500 persons (AC Halls & Open Area).

# fourth floor plan



- |              |                            |              |           |      |
|--------------|----------------------------|--------------|-----------|------|
| FOOD COUNTER | FOOD COURT SITTING AREA    | CASH COUNTER | F&B       | SHOP |
| FOOD COUNTER | FOOD COURT SITTING AREA    | CASH COUNTER | F&B       | SHOP |
| DRY COUNTER  | FOOD COURT OUTDOOR SITTING | TERRACE      | MULTIPLEX |      |

GALAXY BLUE SAPPHIRE PLAZA FOURTH FLOOR SALE PLAN



# entertainment zone

**GREAT MOVIE EXPERIENCE**  
**12-SCREEN MEGAPLEX | COMFORTABLE SEATS**  
**EXCLUSIVE WAITING LOUNGE**

Galaxy Blue Sapphire Plaza a paradise for those looking for the ultimate cinematic experience! The megaplex is master planned to ensure that you and your loved ones enjoy each moment spent here in the midst of exotic ambiance.

# fifth floor plan



- ENTERTAINMENT
- MULTIPLEX
- F&B
- SHOP

## GALAXY BLUE SAPPHIRE PLAZA - FIFTH FLOOR SALE PLAN



## gaming zone

**EXCLUSIVE KID'S GAMING ZONE  
ARENA FOR AMUSEMENT & ADVENTURE  
ATTRACTIONS FOR THE ENTIRE FAMILY**

The Gaming Zone is an exciting, innovative and creative social enterprise that provides free, open-access facilities and support for children and young people.

The city is home to several amusement parks, gaming centres and bowling alleys, where visitors can indulge in a range of thrilling activities.

# sixth floor plan

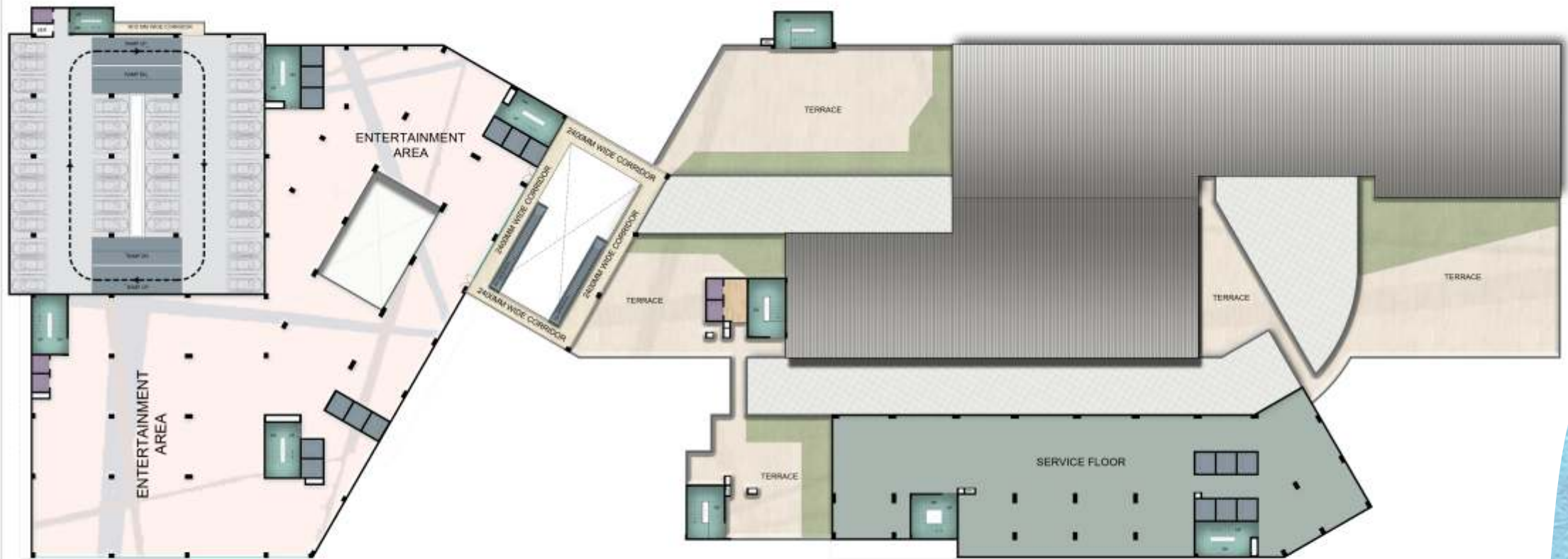

- ENTERTAINMENT
- ENTERTAINMENT
- SERVICE(OFFICE AREA)

## GALAXY BLUE SAPPHIRE PLAZA - SIXTH FLOOR SALE PLAN



## banquet hall

Galaxy Blue Sapphire Plaza Banquet is a Friends and family assemble for a wedding of the special couple, reception, birthday parties

Creating a gorgeous setting for the special day by coordinating the wedding and reception decor with elegant floral arrangements, exquisite table settings, and special touches makes the event more special.

# seventh floor plan



- BANQUET LAWN AREA
- PRE FUNCTION AREA
- KITCHEN
- BANQUET

- BANQUET LAWN AREA
- PRE FUNCTION AREA
- KITCHEN
- BANQUET



# location map

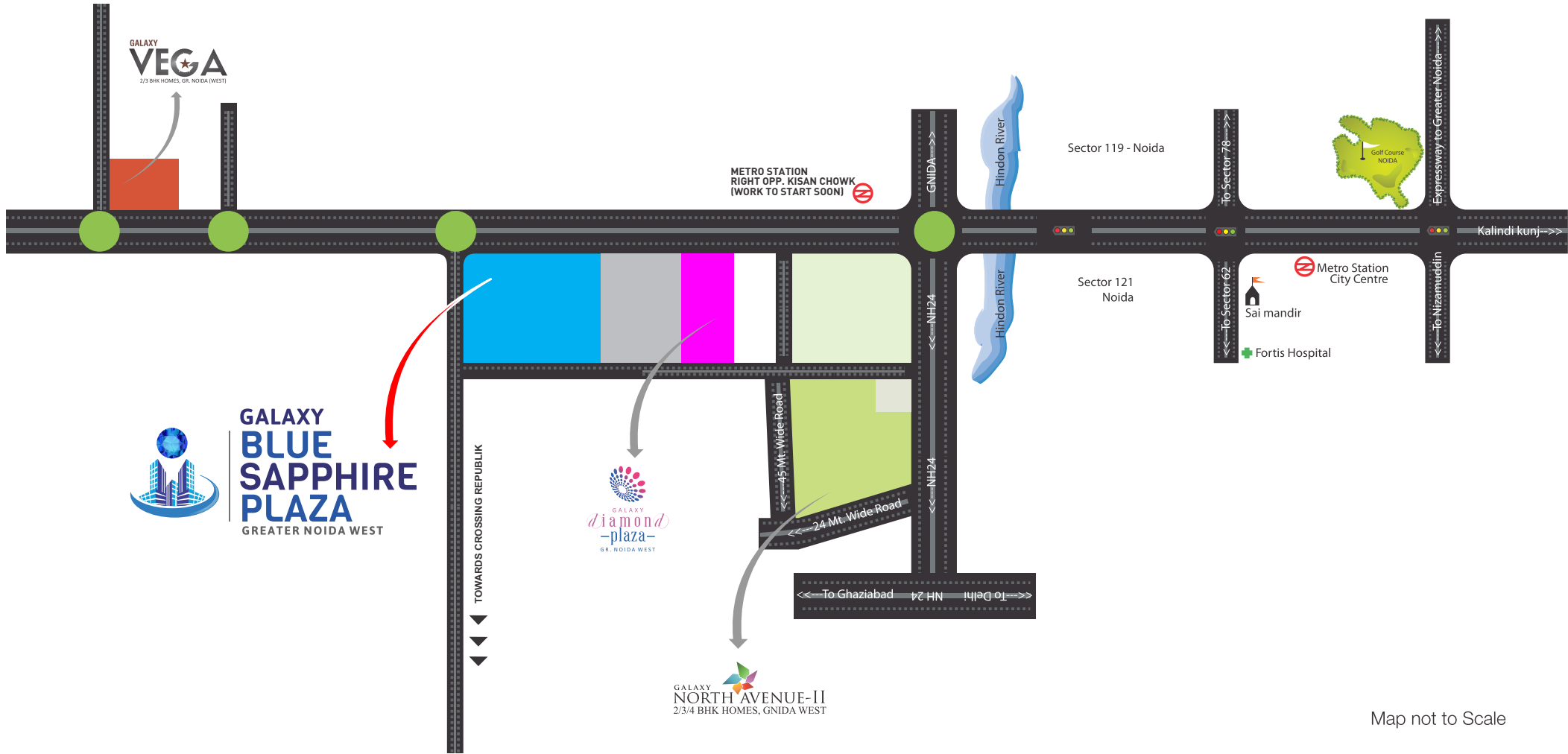

Map not to Scale

---

**RESIDENTIAL PROJECTS**

---



GALAXY  
**NORTH AVENUE-II**  
2/3/4 BHK HOMES, GNIDA WEST



GALAXY  
**VEGA**  
2/3 BHK HOMES, GR. NOIDA (WEST)



GALAXY  
**royale**

---

**COMMERCIAL PROJECTS**

---



GALAXY  
*Diamond*  
-plaza-  
GR. NOIDA WEST



**Galaxy  
Plaza**  
GREATHER CITY Greater Noida (West)



**Galaxy  
Shoppe**  
GREATHER CITY Greater Noida (West)



galaxy  
Green  
**arcade**

Retail & Hyper Market | Bangkok Bazaar | Medicenter | Food Court  
Entertainment Zone | Gaming Zone | Banquet Hall

**GLD INFRAPROJECTS PRIVATE LIMITED**

Corp. Office: H-175, Sector-63, Noida-201301 (U.P.)

Site Office: Plot No. C-03, Sector-4, Greater Noida | Email: [info@thegalaxygroup.com](mailto:info@thegalaxygroup.com) | [www.thegalaxygroup.com](http://www.thegalaxygroup.com)

**Call: 92110 88000 | sms "GALAXY" to 54242**